

# Cool Cube™ 28 at Fridge Temps (Blood Products)

Model: BT-28



The Cool Cube™ 28 at Fridge Temperatures for Blood Products is not an ordinary transport cooler. It is a lockable, wheeled, validated container and pack-out system that keeps temperature sensitive product (whole blood, RBCs, liquid plasma) chilled between 1 and 10 °C for over 4½ days (or between 1 and 6 °C for over 2½ days) – without using ice or electricity! This cooler is ideal for transport, but also excels at protecting valuable product during off-site use and power outages, regardless of hot or freezing conditions. The simple, validated, patented technology is the best compact thermal protection product available to maintain the cold chain!



## Validated Pack-Out System

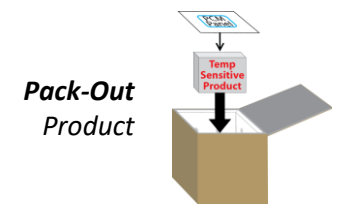
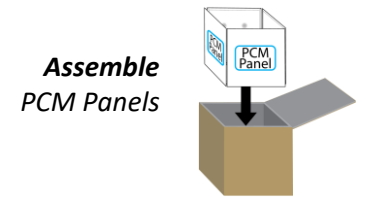
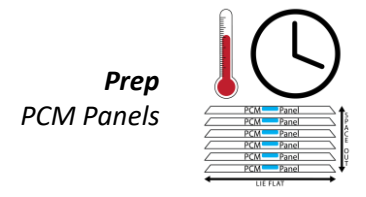
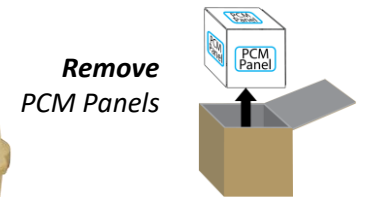

- 1 Integrated towing handle for easy transport.
- 2 Holder and flexible grommet enables the use of an external temp monitor.
- 3 Tru-Trac System™ - a user-friendly wheel configuration.
- 4 Six removable, temperature-controlling, PCM panels ensure a simple, quick & effective pack-out.

### Features

- 6 patented refrigerator PCM panels manage the temp
- Temp-Shield™ vacuum insulated panel (VIP) system
- Rugged, military spec case with large lifting handles & wheels
- Validated under ISTA Test Procedure 7D (Int'l Safe Transit Assoc.)

### Specifications

*Temperature Range / Duration*  
 1 to 6 °C (34 to 42 °F) / 68+ hrs.  
 1 to 10 °C (34 to 50 °F) / 108+ hrs.

*Payload Area*  
 12" x 12" x 12"

*Exterior Dimensions & Weight*  
 20½" x 20½" x 23" @ 61 lbs.

[Go to Web Page >>](#)



info@VeriCorMed.com  
 (608) 526-6901

For more information & pricing: [www.VeriCorMed.com](http://www.VeriCorMed.com)

